

SD-750N

**HIGH FREQUENCY
COMPRESSION DRIVER**

SD-Series



MODEL: SD-750N

49 mm. 2 in EXIT

Compression Driver

72 mm. 2.84 in Diaphragm

SPECIFICATIONS

Size (in)	: 135.0 mm 5.3 In
Rated Impedance	: 8 ohm
Power Handling Capacity	: 125 W (rms)
Sensitivity 1W@1m	: 111 dB
Operating Bandwidth	: 600 Hz - 20K Hz
Throat Diameter	: 51.00 mm 2.0In
Recommended Crossover	: 2nd. order or Higher

Thiele - Small Parameters

Resonance Frequency	: Fs	645.0 Hz
DC Resistance	: Re	6.2
Mechanical Q Factor	: Qms	10.078
Electrical Q Factor	: Qes	0.934
Total Q Factor	: Qts	0.855

Physical Information

Basket Material	: Die cast Aluminum
Diaphragm Material	: Titanium
Magnet Type	: Neodymium
Terminal	: Gold Plated Push
Mounting Type	: Bolt On
Voice Coil Former	: Nomex
Voice Coil Material	: Aluminium Flat Wire 300°C
Net Weight	: 3.3 kg 7.26Lb/pcs
Gross Weight	: 3.6 kg 7.92Lb/pcs
Packing Dimension WxLxH (mm)	: 170 X 170 X 120 6.6in X 6.6in X 4.7in



Motor Assembly Design.
1008 Cold Roll Steel With
Copper Shorting Ring.

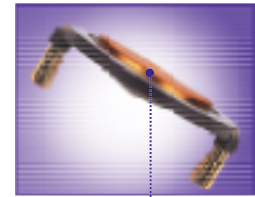

**2.84" Pure Titanium
Diaphragm With Edge Wound
Aluminum Ribbon Voice coil.**

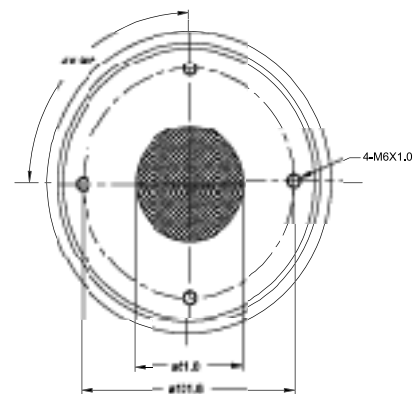

BOT IOM VIEW

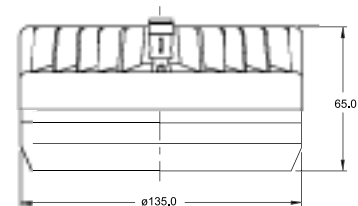

SIDE VIEW

